

# PRODUCT MANUAL

Intelligence · Technology · Security

## Download "V380 Pro" APP

Search for "V380 Pro" in the App Store or scan the QR code at the bottom left to download and install the V380 Pro APP.



Scan the QR code to download the V380 Pro app



Scan the QR code to view more Instructions or video tutorial

## Device initialization

First time to use camera, please be patient to setting.

Please add your device to app after you hear the voice to confirm that the device has been started.

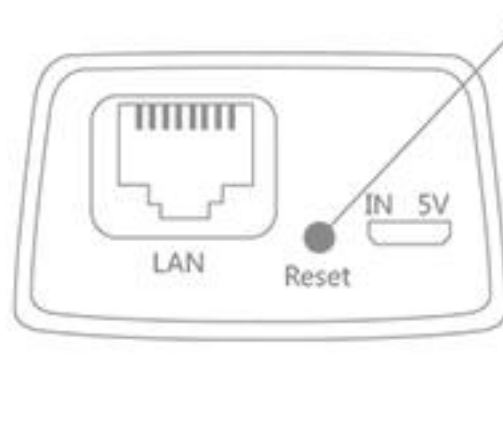

Reset button

Press "Reset" button for 5 second to Restore factory settings.

(The position of the Reset button is for reference only, and the specifics are subject to the device you have)

## Choose the type of your camera

Please select the corresponding connection method according to your camera type.

• For the devices which using WiFi or network cables, please select **"WiFi Smart Camera"**.

\*5G WiFi is temporarily not supported

• For 4G camera, please select **"4G Smart Camera"** and add your device by scanning the QR code.

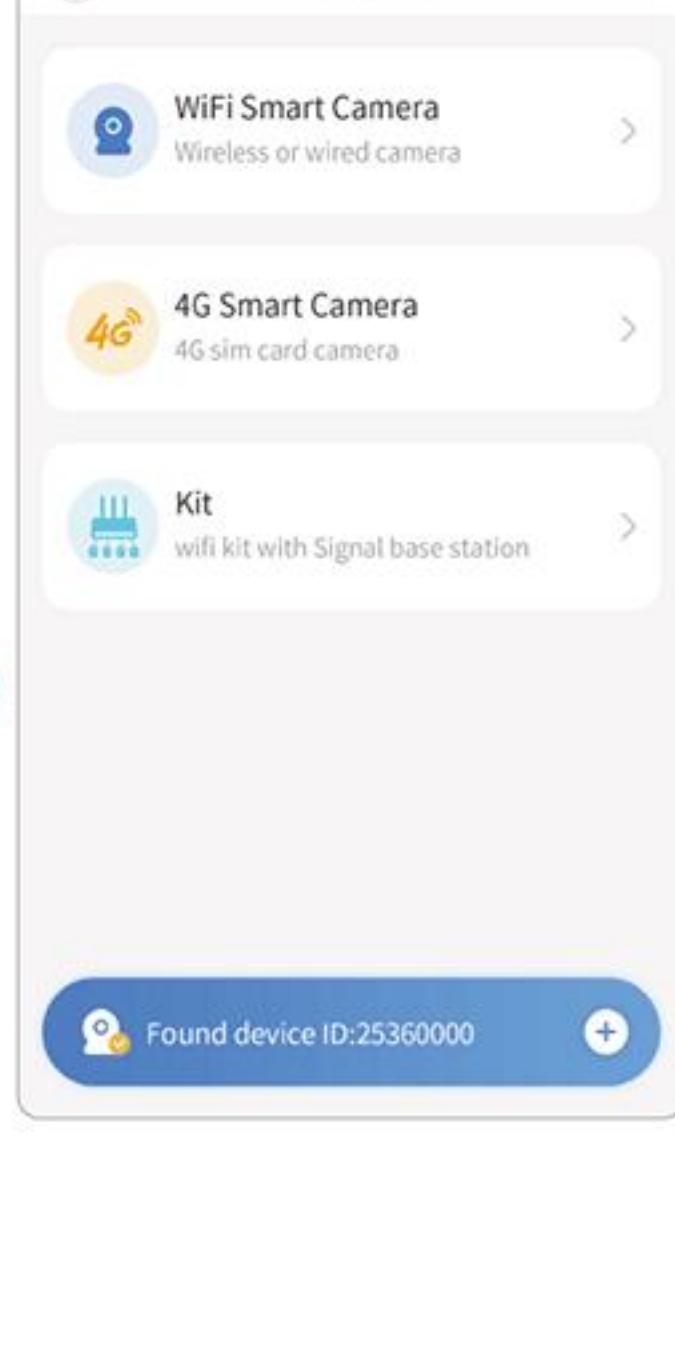

### WiFi Smart Camera

\*Before adding a wireless camera, please turn on the mobile WiFi first.

#### AP hotspot connection (Android)

1. Please Select "AP hotspot connection".
2. Select WiFi and input the password.
3. APP automatically detects the devices.Please select your device.

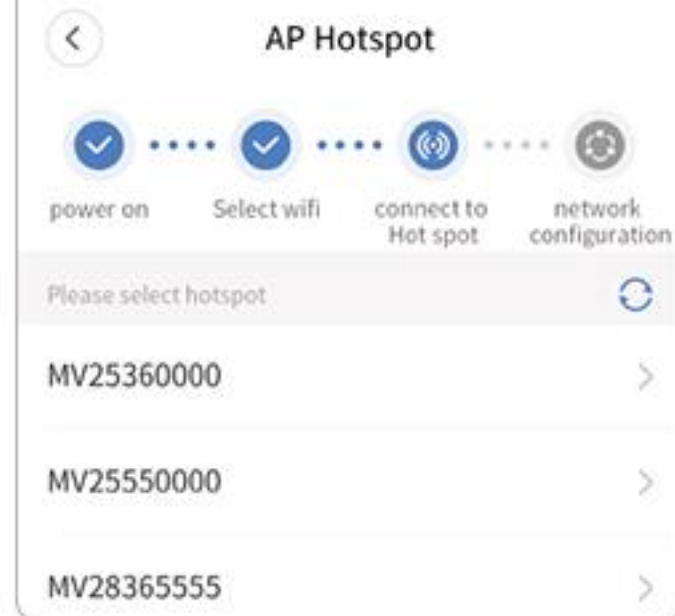

#### AP hotspot connection (iPhone)

- 1.Please connect your mobile phone to WiFi first. After the connection is complete, select "AP Hotspot Connection".
- 2.Input the WiFi password (if you want to connect to other WiFi router, please connect your phone to that WiFi first and return to the APP to refresh.
3. Tap the " Hotspot setting" button.Connect to the device hotspot (MV+ID), the device will automatically connect to WiFi after returning to the App.

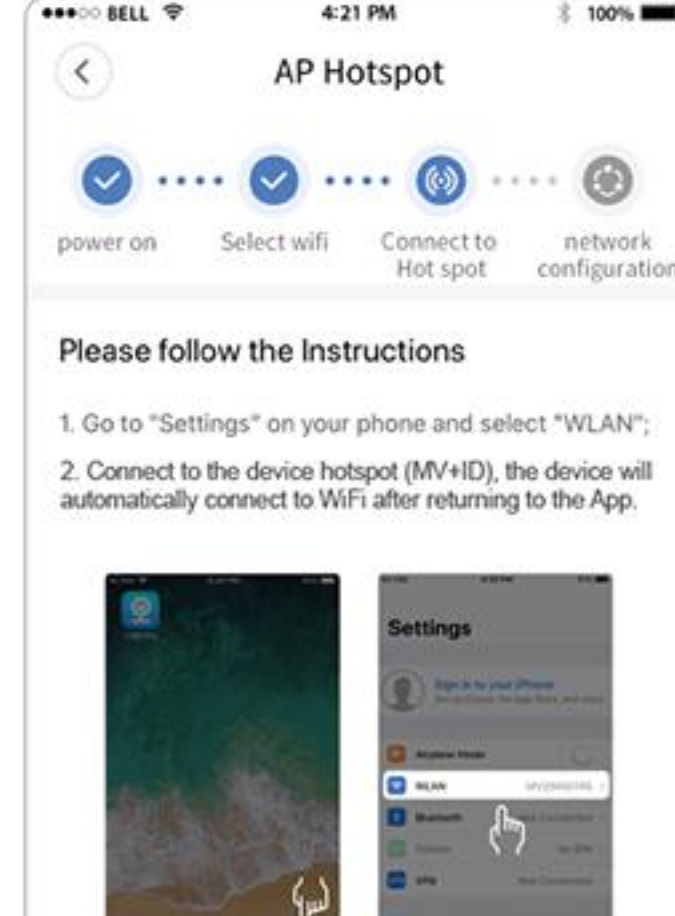
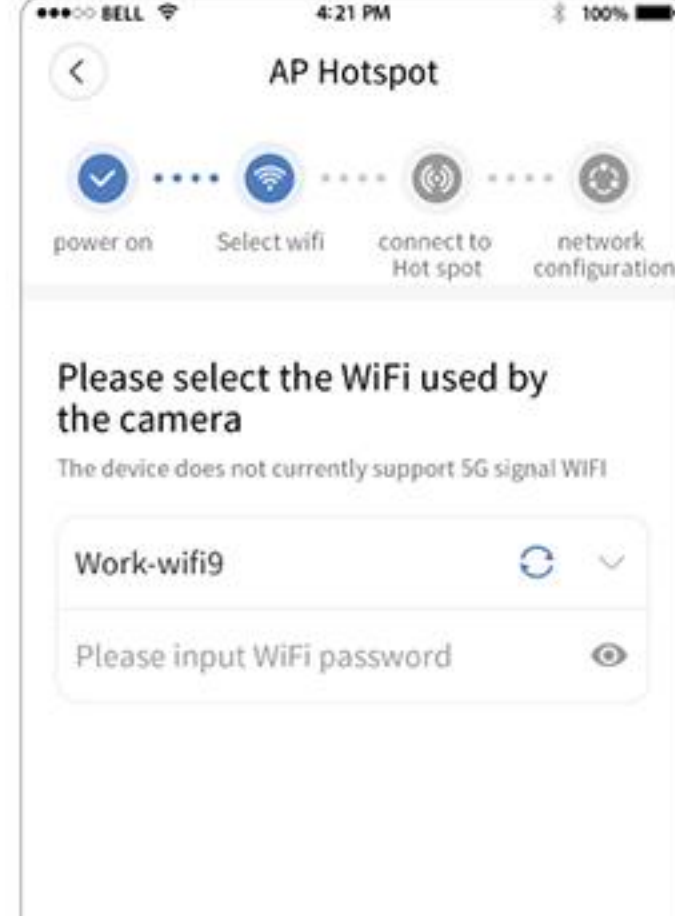

#### WiFi smart-link connection

- 1.Input WiFi password.
- 2.Input the device ID number to increase the configuration success rate (or scan the QR code), and tap the "Next" button.

\*When the device is in the "WiFi smart-link connection" mode, you can short press the Reset button for 1 second to switch to the AP hotspot connection mode.

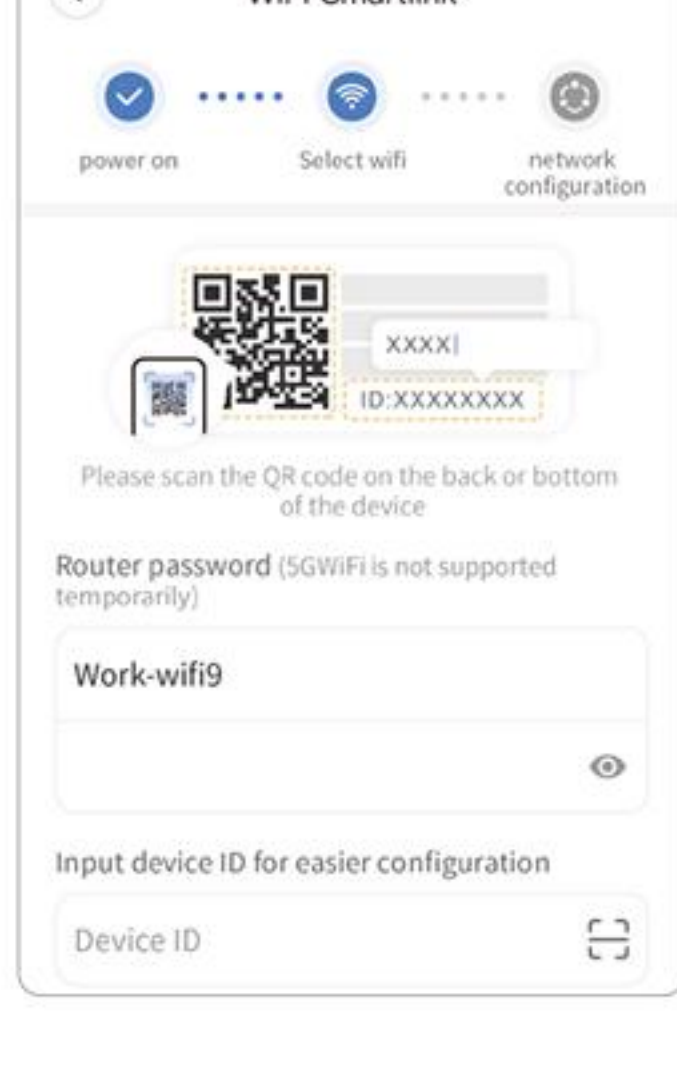

### 4G Smart Camera

1. Open the bottom cover of the camera body, install the SIM card and TF card, and then close the bottom cover to finish the installation (embedded SIM card camera does not need to be installed).
2. Power on the camera, waiting for 1 minute; when camera prompts "connection completed", please use APP to scan the QR code on the camera to add device.

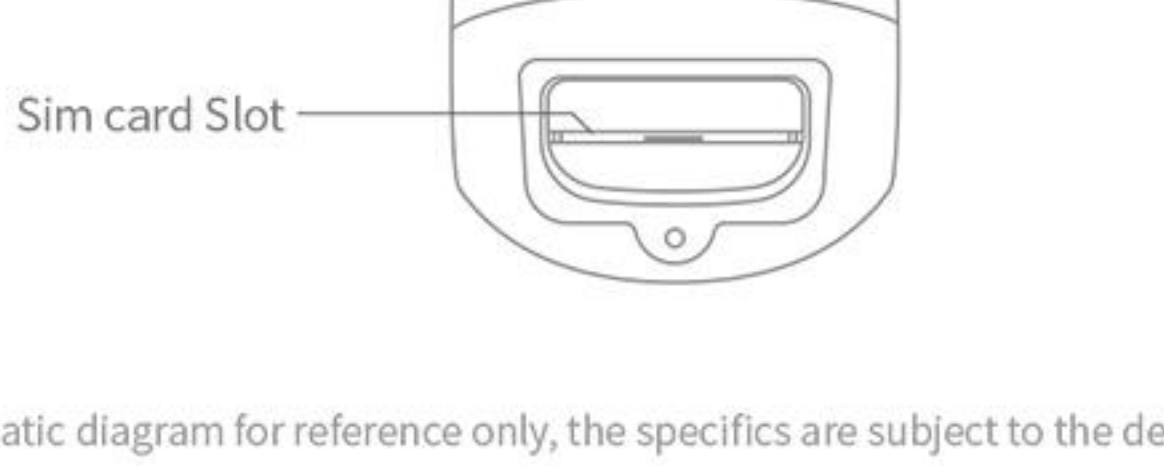

\*schematic diagram for reference only, the specifics are subject to the device you have)

- 3.when camera prompts "Successful connection", please use APP to scan the QR code on the camera to add device.
4. After added the camera, you can check the remaining data and recharge data on main screen or check it in "Profile".

